

Jumping Jet - JJ Series

Function

The Jumping jet produces a parabolic water rod which is a clear and continuous tube of water until it falls down. The advanced technology used in this device allows the water rod to be cut at programmed intervals. The water rods are instantaneously cut so that the shape and illumination is retained. Jumping jets are equipped with an LED light and when illuminated at night becomes an amazing attraction as the lights travels inside the stream of water. Fine filtration is a key requirement for this kind of water feature. Recommended to use with screen discharge filter (SF series).



Specifications

Jumping jet Material

Stainless steel 316

Connection Sizes

1" BSP Inlet connection

Stand adjustment

0° - 90°

Protection Rating:

Jumping jet: IP 68

Voltage - Light & Cutter

24V DC

Power

Light: 5 - 8W

Cutter: 48W

Light Colours

RGBW / White

Cable Size

4 C - 1 mm² (DMX light)

2 C - 1.5 mm² (White light)

4 C - 1 mm² (Cutter)

Standard Cable Length

1.5 m x2

(Custom length available on request)

Light and Cutter Material:

Stainless steel 316

Protection Rating:

Jumping Jet: IP 68

Light: IP 68, IK 10

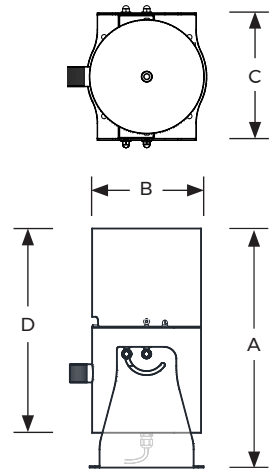

Model No.	Inlet (BSP)	Colour	Control	Light Power (W)	Cutter Power (W)	W1 (mm)	A (mm)	B (mm)	C (mm)	D (mm)
JJ-100	1"	RGBW	DMX	8	48	185	468	219	247	413
JJ-101	1"	Cool white	On/off	5	48	185	468	219	247	413
JJ-102	1"	Warm white	On/off	5	48	185	468	219	247	413

* Add suffix DMX to model number to order DMX controlled white light. i.e. JJ-102-DMX

* Add suffix AUTO to model number to order Auto colour changing effect for RGBW light. i.e. JJ-100-AUTO

Angle	Throw Height (meters)	Throw Distance (meters)	Flow (LPM)	Pressure Head (m)	Optimal
@ 75°	1.5	1.5	15	2.3	Optimal
	2	2	17.4	2.9	
	2.5	2.5	19.5	3.5	
	3	3	21.4	4.2	
	3.5	3.5	23.3	4.9	
@ 70°	1.5	2.1	15.4	2.3	Optimal
	2	2.9	17.6	3.1	
	2.5	3.6	19.8	3.8	
	3	4.2	22	4.6	
	3.5	5	24.6	5.4	
@ 60°	1	2.3	13.7	1.8	Optimal
	1.5	3.4	16.8	2.6	
	2	4.5	19.6	3.6	
	2.5	5.6	22	4.5	
	3	6.7	24.5	5.5	

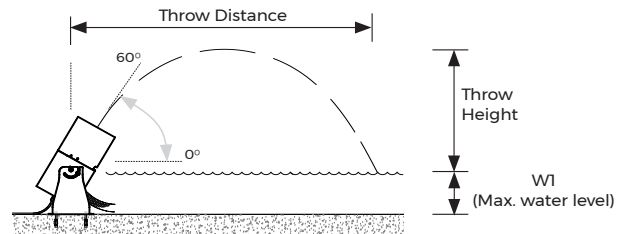

Laminar Water Parabolas @ different angles

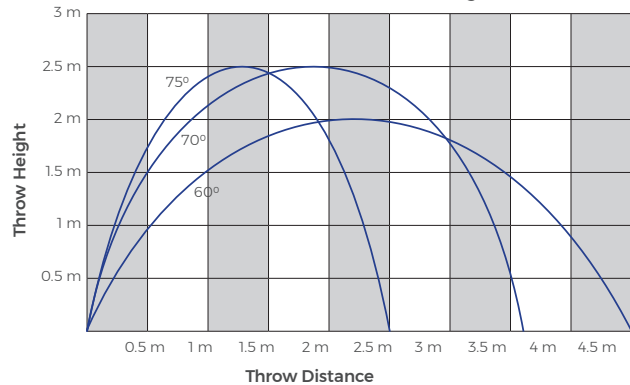

Jumping Jet	JJ Series	Model No. JJ	Rev. 2	
<p>The information contained in this drawing is the sole property of Aquashi. Any reproduction in part or as a whole without the written permission of Aquashi is prohibited. Aquashi reserves the right to update all designs, specifications and data sheets without prior notice.</p>				

Jumping Jet - JJ Series

Connection Diagram

RGBW Light Cable / Jumping jet Cutter

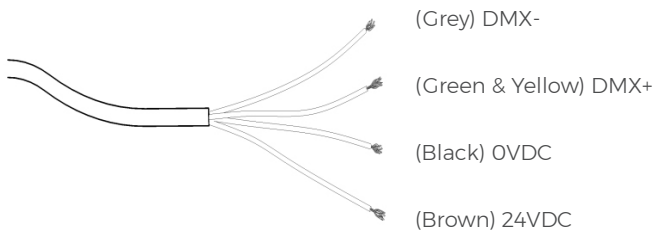

Warm White/ Cool White Light Cable



Typical Installation

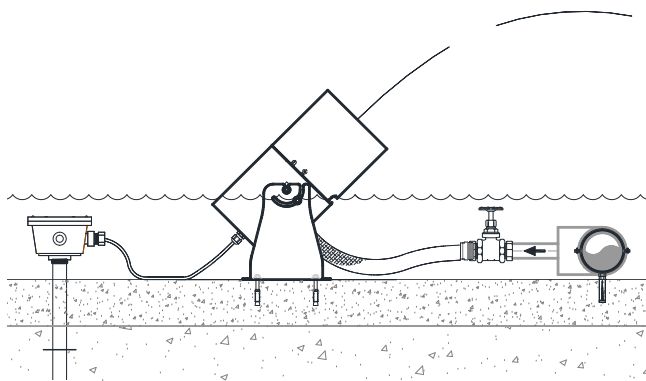

Stand hole measurement

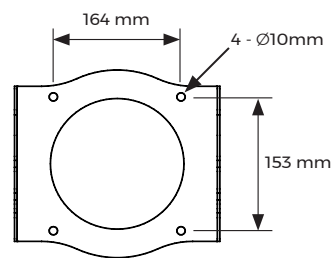

Water Requirements:

This fountain must be used with a clean and steady flow of water. The water quality should meet the water standard for swimming pools in order to achieve good laminar flow and illumination effects.



Precautions:

1. This device is not designed for use in windy environment.
2. Hose connection should be used and the water supply should be steady and stable.
3. Clean the sponge inside the Jumping Laminar tank periodically to ensure the steady water flow.
4. If noise can be heard from the nozzle, please adjust the angle of the fountain by 15°, then change it back to the angle that you desire.

Jumping Jet	JJ Series	Model No. JJ	Rev. 2	
<p>The information contained in this drawing is the sole property of Aquashi. Any reproduction in part or as a whole without the written permission of Aquashi is prohibited. Aquashi reserves the right to update all designs, specifications and data sheets without prior notice.</p>				